

Zone #	Total Flow	Precip Rate
1	37.29 gpm	1.49 in/hr
2	45.28 gpm	1.39 in/hr
3	45.39 gpm	1.89 in/hr
4	49.84 gpm	1.54 in/hr
5	47.85 gpm	1.62 in/hr
6	46.65 gpm	1.64 in/hr
7	34.21 gpm	1.77 in/hr
8	35.37 gpm	1.74 in/hr
9	36.1 gpm	1.78 in/hr
10	30.79 gpm	1.47 in/hr
11	15.74 gpm	4.75 in/hr
12	40.62 gpm	1.57 in/hr
13	26.28 gpm	1.59 in/hr
14	54.17 gpm	1.55 in/hr
15	38.54 gpm	1.93 in/hr
16	36.77 gpm	1.84 in/hr
17	41.85 gpm	0.56 in/hr
18	29.17 gpm	0.25 in/hr
19	29.17 gpm	0.25 in/hr
20	31.44 gpm	1.41 in/hr
21	40.47 gpm	0.45 in/hr
22	49.84 gpm	0.45 in/hr
23	44.48 gpm	0.37 in/hr
24	48.7 gpm	0.4 in/hr
25	50.43 gpm	0.4 in/hr
26	19.41 gpm	1.43 in/hr

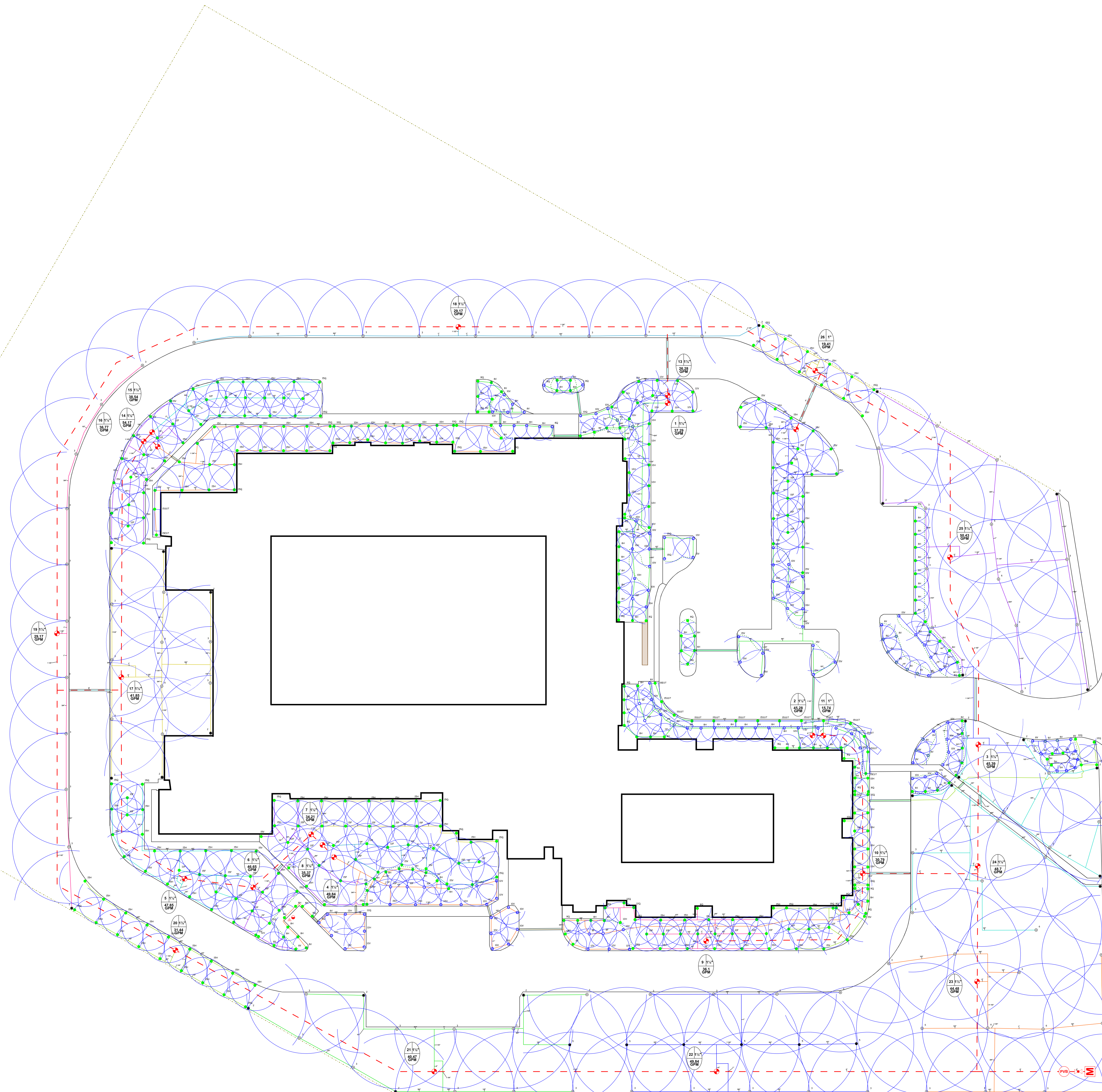

Symbol	Description	Pressure	Flow	Radius
●	Rain Bird 10F - 1804-PRS	30 psi	1.58 gpm	10 ft
○	Rain Bird 10F - 1812-PRS	30 psi	1.58 gpm	10 ft
○	Rain Bird 10H - 1804-PRS	30 psi	0.79 gpm	10 ft
○	Rain Bird 10H - 1812-PRS	30 psi	0.79 gpm	10 ft
○	Rain Bird 10Q - 1804-PRS	30 psi	0.39 gpm	10 ft
○	Rain Bird 10Q - 1812-PRS	30 psi	0.39 gpm	10 ft
○	Rain Bird 10-VAN 180 - 1804-PRS	30 psi	1.45 gpm	10 ft
○	Rain Bird 10-VAN 180 - 1812-PRS	30 psi	1.45 gpm	10 ft
○	Rain Bird 10-VAN 90 - 1812-PRS	30 psi	0.79 gpm	10 ft
○	Rain Bird 12F - 1804-PRS	30 psi	2.6 gpm	12 ft
○	Rain Bird 12H - 1804-PRS	30 psi	1.3 gpm	12 ft
○	Rain Bird 12H - 1812-PRS	30 psi	1.3 gpm	12 ft
○	Rain Bird 12Q - 1804-PRS	30 psi	0.65 gpm	12 ft
○	Rain Bird 12Q - 1812-PRS	30 psi	0.65 gpm	12 ft
○	Rain Bird 12-VAN 180 - 1804-PRS	30 psi	1.3 gpm	12 ft
○	Rain Bird 12-VAN 180 - 1812-PRS	30 psi	1.3 gpm	12 ft
○	Rain Bird 12-VAN 90 - 1804-PRS	30 psi	0.65 gpm	12 ft
○	Rain Bird 12-VAN 90 - 1812-PRS	30 psi	0.65 gpm	12 ft
○	Rain Bird 15E5T - 1804-PRS	30 psi	0.61 gpm	15 x 4 ft
○	Rain Bird 15F - 1804-PRS	30 psi	3.7 gpm	15 ft
○	Rain Bird 15H - 1804-PRS	30 psi	1.85 gpm	15 ft
○	Rain Bird 15H - 1812-PRS	30 psi	1.85 gpm	15 ft
○	Rain Bird 15Q - 1804-PRS	30 psi	0.92 gpm	15 ft
○	Rain Bird 15Q - 1812-PRS	30 psi	0.92 gpm	15 ft
○	Rain Bird 15S5T - 1804	30 psi	1.21 gpm	30 x 4 ft
○	Rain Bird 15-VAN 180 - 1804-PRS	30 psi	1.85 gpm	15 ft
○	Rain Bird 15-VAN 180 - 1812-PRS	30 psi	1.85 gpm	15 ft
○	Rain Bird 15-VAN 90 - 1804-PRS	30 psi	0.92 gpm	15 ft
○	Rain Bird 15-VAN 90 - 1812-PRS	30 psi	0.92 gpm	15 ft
○	Rain Bird 5000 Series 2.0 - 5004-PL-PC-2.0	45 psi	2.07 gpm	37 ft
○	Rain Bird 5000 Series 3.0 - 5004-PL-PC-3.0	35 psi	2.71 gpm	38 ft
○	Rain Bird 5000 Series 5.0 - 5004-PL-FC	45 psi	5.09 gpm	45 ft
○	Rain Bird 5000 Series 6.0 - 5004-PL-FC	35 psi	5.23 gpm	43 ft
○	Rain Bird 5H - 1804-PRS	20 psi	0.16 gpm	4 ft
○	Rain Bird 5H - 1812-PRS	30 psi	0.2 gpm	5 ft
○	Rain Bird 8F - 1812-PRS	30 psi	1.05 gpm	8 ft
○	Rain Bird 8H - 1804-PRS	30 psi	0.52 gpm	8 ft
○	Rain Bird 8H - 1812-PRS	30 psi	0.52 gpm	8 ft
○	Rain Bird 8Q - 1804-PRS	30 psi	0.26 gpm	8 ft
○	Rain Bird 8Q - 1812-PRS	30 psi	0.26 gpm	8 ft
○	Rain Bird 8-VAN 180 - 1804-PRS	30 psi	1.19 gpm	8 ft
○	Rain Bird 8-VAN 180 - 1812-PRS	30 psi	1.19 gpm	8 ft
○	Rain Bird 8-VAN 90 - 1804-PRS	30 psi	0.72 gpm	8 ft
○	Rain Bird 8-VAN 90 - 1812-PRS	30 psi	0.72 gpm	8 ft

- Water Source: 2 inch meter
- Backflow Devices: Fobco 765 - 2"
- Control Valves: Rain Bird 100-PGA Globe, Rain Bird 150-PGA Globe
- Irrigation Accessories: Rain Bird 2" isolation valve, Rain Bird ESP-30MC, Rain Bird Rain Check
- Lateral Line Pipe: Class 315 1/2", Class 200 3/4", Class 200 1", Class 200 1 1/4", Class 200 1 1/2", Class 200 2"
- Mainline Pipe: Class 200 1 1/4", Class 200 1 1/2", Class 200 2"
- Drip Tubing: Netofim TLCV6-12

Run Set: 14

Water Source #1	
Type:	Meter
Static Pressure:	62 psi
Service Line:	0.447 psi
Meter Loss:	2.15 psi

Mainline Components	
Backflow Loss:	3.177 psi
Master Valve Loss:	0 psi
Filter Loss:	0 psi

Zone 14 @ 54.17 gpm	
Mainline Loss:	17.16 psi
Valve Loss:	5.851 psi
Lateral Loss:	4.731 psi
Fittings Loss:	2.189 psi
Elevation:	0 psi
Sprinkler Requirement:	30 psi
Total Design Pressure:	60.516 psi
Residual Pressure:	1.516 psi

Water Source #1	
Meter Size:	2 inch meter
Metric Pressure:	62 psi
Elevation Change:	0 ft

Service Line Information	
Pipe Category:	Type K Copper
Pipe Size:	Type K Copper 2"
Length:	15 ft
Velocity:	4 ft/s

Recommendations	
Maximum Recommended Flow:	56.17 gpm
Available Working Pressure:	54.05 psi

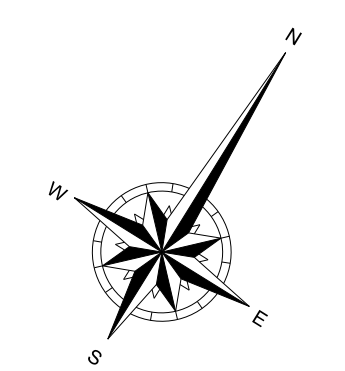

Welsh Irrigation

SHEET DESCRIPTION:
Irrigation Design

PROJECT:
Signature Senior Living
Conroe, Tx.

REVISIONS:
None

DATE:
12/30/2009

JOB NUMBER:
123009

DRAWN BY:
JW

CHECKED BY:
JW

SCALE:
1" = 30'

SHEET:
1 of 1